

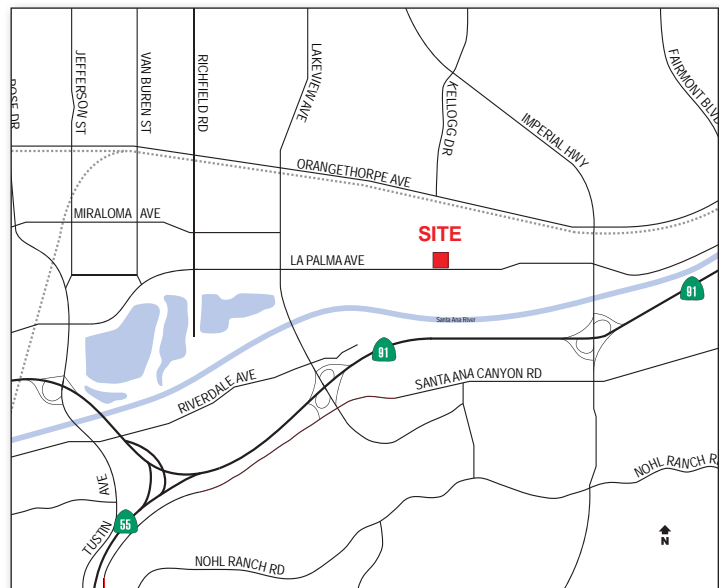

Features:

- High Image Two-Story Industrial Building
- ±6,707 Sq. Ft. of Two-Story Office Space
- 30' Warehouse Clearance
- 2 Dock High Loading Doors
- 1 Grade Level Loading Door
- Fenced Secured Yard
- 2:1 Parking Ratio
- Excellent Access to 3 Major Freeways , 91, 57, & 55 Freeway
- Desirable East Anaheim Location with La Palma Street Frontage



Mitch Zehner
Executive Vice President
714.935.2307
Lic. #00882464

Seth Davenport
Executive Vice President
714.935.2376
Lic. #01413387

Voit
REAL ESTATE SERVICES

**THE ZEHNER
DAVENPORT
INDUSTRIAL GROUP**

2400 E. Katella Avenue, Suite 750, Anaheim, CA | 714.978.7880 714.978.8329 Fax | zehnerdavenport.com

Licensed as Real Estate Salespersons by the CA Bur of Real Estate. The information contained herein has been obtained from sources we deem reliable. While we have no reason to doubt its accuracy, we do not guarantee it. ©2016 Voit Real Estate Services, Inc. All Rights Reserved. License #01333376

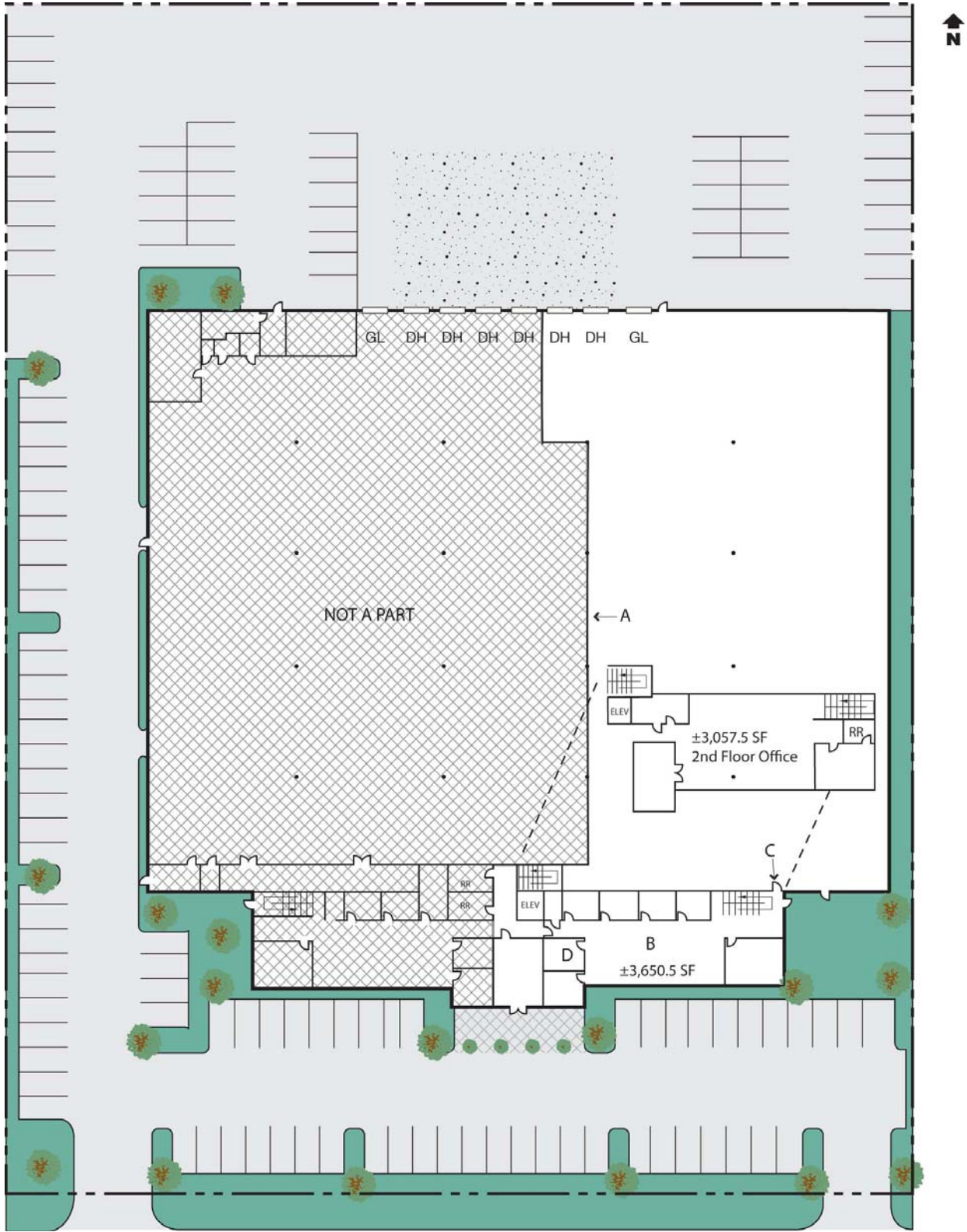

Mitch Zehner
Executive Vice President
714.935.2307
Lic. #00882464

Seth Davenport
Executive Vice President
714.935.2376
Lic. #01413387

