



±27,840 SF

REAL PEOPLE, REAL SOLUTIONS®



AVAILABLE FOR LEASE

PROPERTY DETAILS:

- Freestanding Manufacturing / Distribution Building
- 27,840 Square Feet of Office Space
- Excellent Corporate Location in Fullerton
- Building with Excellent Truck Circulation
- Large Staging Area
- 1600 AMPS (verify)
- Fire Sprinklered .45/3,000
- 24' Warehouse Clearance
- Concrete Loading Aprons
- 1 Ground Level Loading Door (12'x14')
- 5 Dock High Loading Doors (9'x11')
- Access of two major street (Artesia & Commonwealth)
- Immediate Freeway Access to  & 



2330 ARTESIA AVENUE
SUITE B
FULLERTON, CA

Southern California's Premier
Real Estate Marketing Team



MITCH ZEHNER
Executive Vice President
714.935.2307
mzehner@voitco.com
Lic#00882464



SETH DAVENPORT
Executive Vice President
714.935.2376
sdavenport@voitco.com
Lic#01413387

Voit
REAL ESTATE SERVICES

**THE ZEHNER
DAVENPORT**
INDUSTRIAL GROUP

AVAILABLE FOR LEASE - ± 27,840 SF

2330 ARTESIA AVENUE, STE. B, FULLERTON

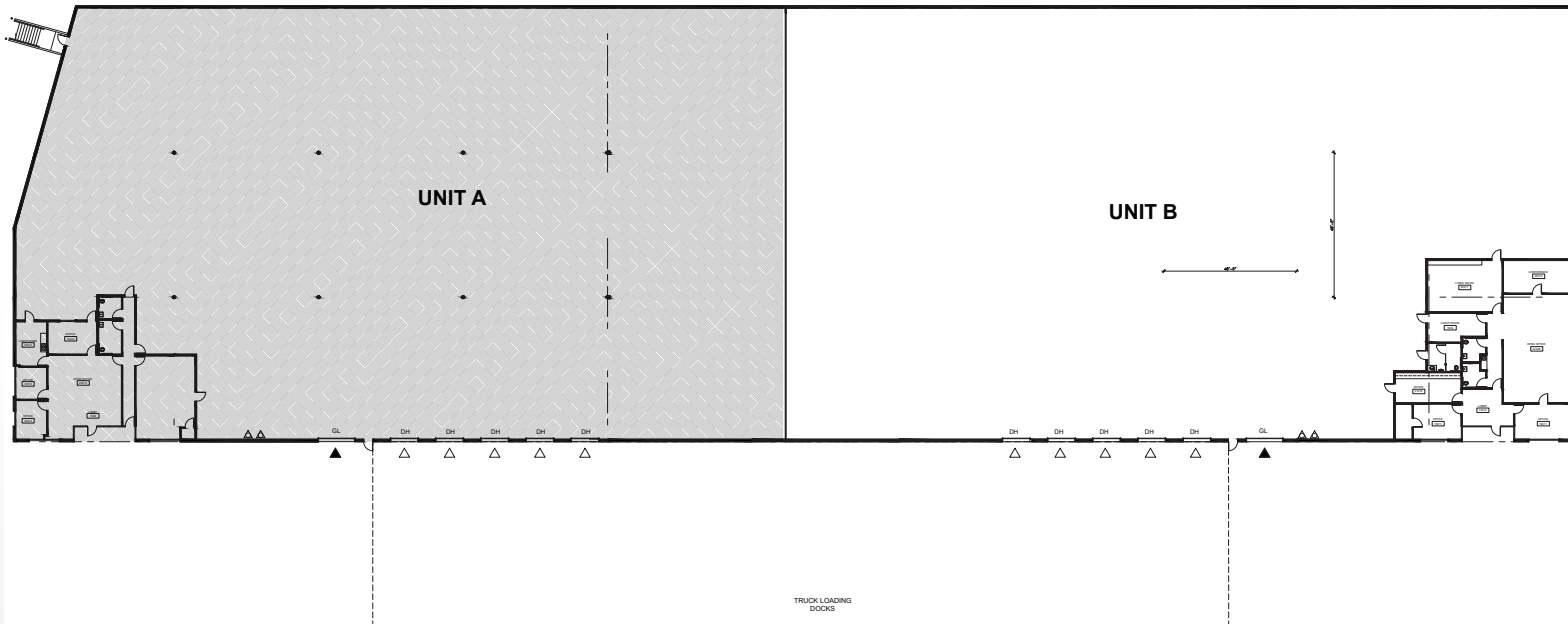

* Site Plan Not to Scale

Southern California's Premier
Real Estate Marketing Team



MITCH ZEHNER
Executive Vice President
714.935.2307
mzehner@voitco.com
Lic#00882464



SETH DAVENPORT
Executive Vice President
714.935.2376
sdavenport@voitco.com
Lic#01413387

Voit
REAL ESTATE SERVICES

**THE ZEHNER
DAVENPORT**
INDUSTRIAL GROUP