

1331 N. KRAEMER BLVD

Anaheim, CA

For Lease

±15,180 SF



BUILDING FEATURES

- ±1,600 SF of Office Space
- Kraemer Blvd Street Frontage & Signage
- 3 Grade Level Loading Doors
- 1 Interior Truckwell
- 22' Warehouse Clearance
- 400 Amps of Power
- Shop Restroom
- Fire Sprinklered
- Immediate access to Orange 57 & Riverside 91 Freeways

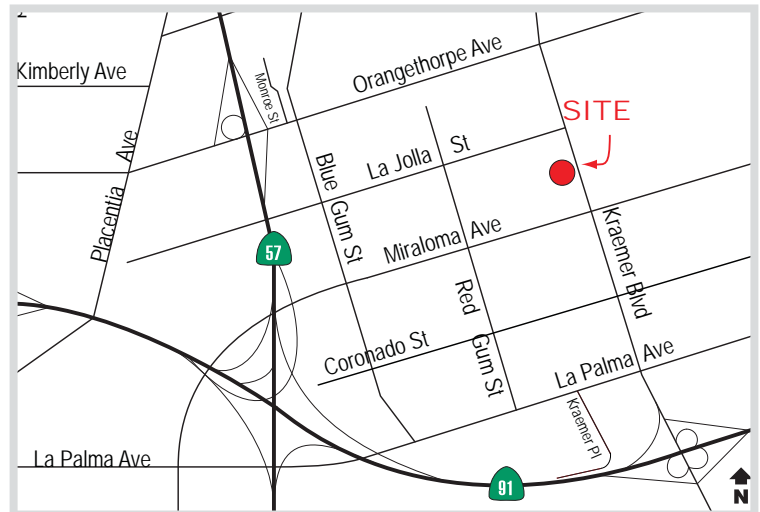

SETH DAVENPORT

Executive Vice President
714.935.2376
Lic. #01413387

MITCH ZEHNER

Executive Vice President
714.935.2307
Lic. #00882464

Voit
REAL ESTATE SERVICES

**THE ZEHNER
DAVENPORT
INDUSTRIAL GROUP**

2400 E. Katella Avenue, Suite 750, Anaheim, CA 92806 • 714.978.7880 • 714.978.8329 Fax

www.voitco.com | www.zehnerdavenport.com

Licensed as Real Estate Salespersons by the CA Bur of Real Estate. The information contained herein has been obtained from sources we deem reliable. While we have no reason to doubt its accuracy, we do not guarantee it. ©2018 Voit Real Estate Services, Inc. All Rights Reserved. License #01991765.

1331 N. KRAEMER BLVD

Anaheim, CA

For Lease

±15,180 SF

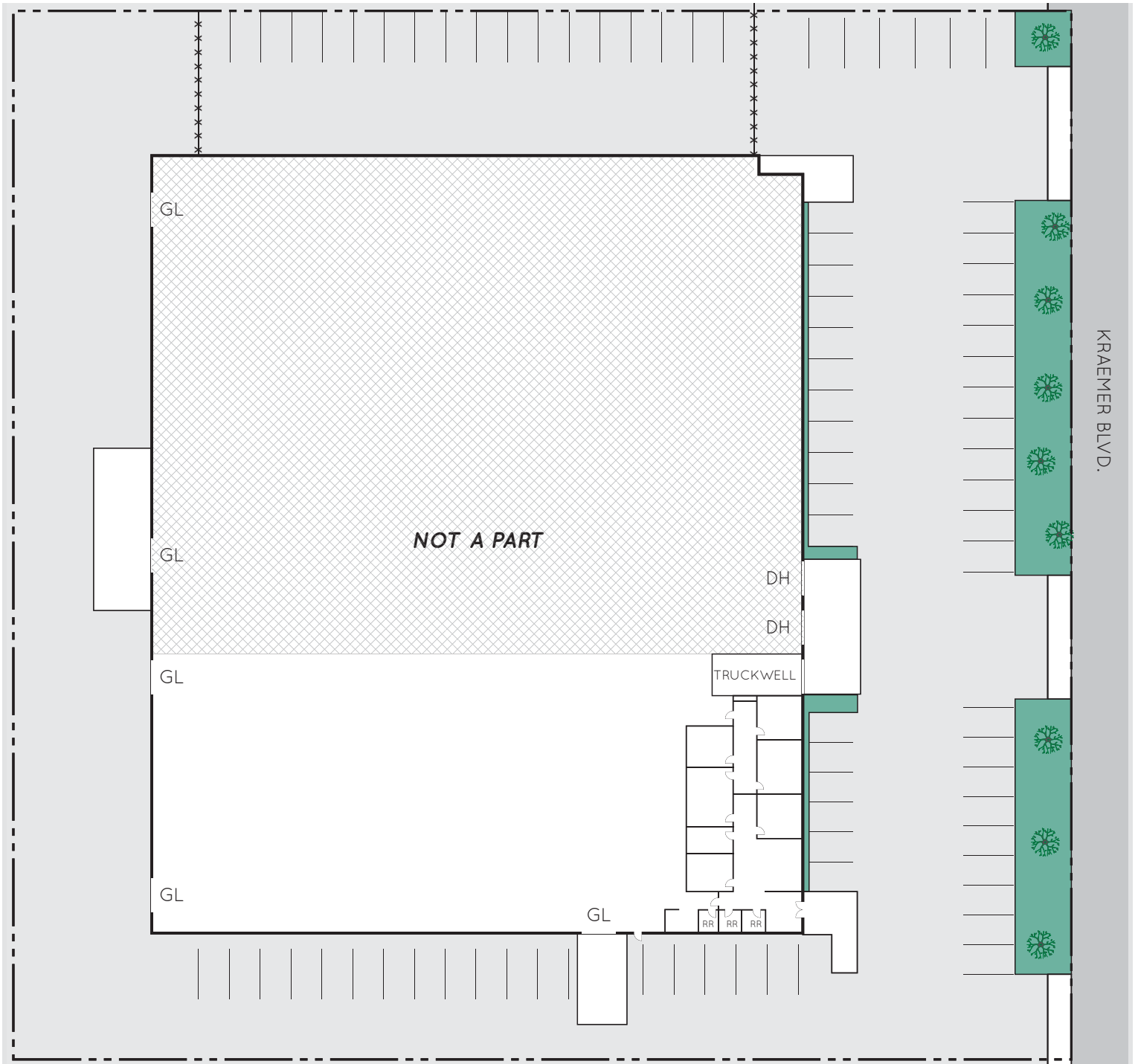

* Site plan is not to scale

SETH DAVENPORT
Executive Vice President
714.935.2376
Lic. #01413387

MITCH ZEHNER
Executive Vice President
714.935.2307
Lic. #00882464

Voit
REAL ESTATE SERVICES

**THE ZEHNER
DAVENPORT
INDUSTRIAL GROUP**

2400 E. Katella Avenue, Suite 750, Anaheim, CA 92806 • 714.978.7880 • 714.978.8329 Fax

www.voitco.com | www.zehnerdavenport.com

Licensed as Real Estate Salespersons by the CA Bur of Real Estate. The information contained herein has been obtained from sources we deem reliable. While we have no reason to doubt its accuracy, we do not guarantee it. ©2018 Voit Real Estate Services, Inc. All Rights Reserved. License #01991765.