

4275 N. PALM ST

Fullerton, CA

For Sublease

121,432 SF



### Building Features

- Part of a Larger 419,417 Square Foot Industrial Building
- 25,500 SF of Office Space
- 20,000 SF of Bonus Mezzanine Space
- 4 Grade Level Loading Doors
- 3 Dock High Loading Doors
- Exterior Truckwell with 2 Docks
- 24' Minimum Warehouse Clearance
- Fully Fire Sprinklered
- 4,000 Amps
- 1.7:1 Parking Ratio
- Excellent proximity to Orange 57 & Riverside 91 Freeways
- Sublease Until 12/31/2018



#### ADAM HILL

Senior Associate  
714.935.2311  
Lic. #01970562

#### SETH DAVENPORT

Executive Vice President  
714.935.2376  
Lic. #01413387

#### MITCH ZEHNER

Executive Vice President  
714.935.2307  
Lic. #00882464



4275 N. PALM ST

Fullerton, CA

For Sublease

121,432 SF

1st Floor

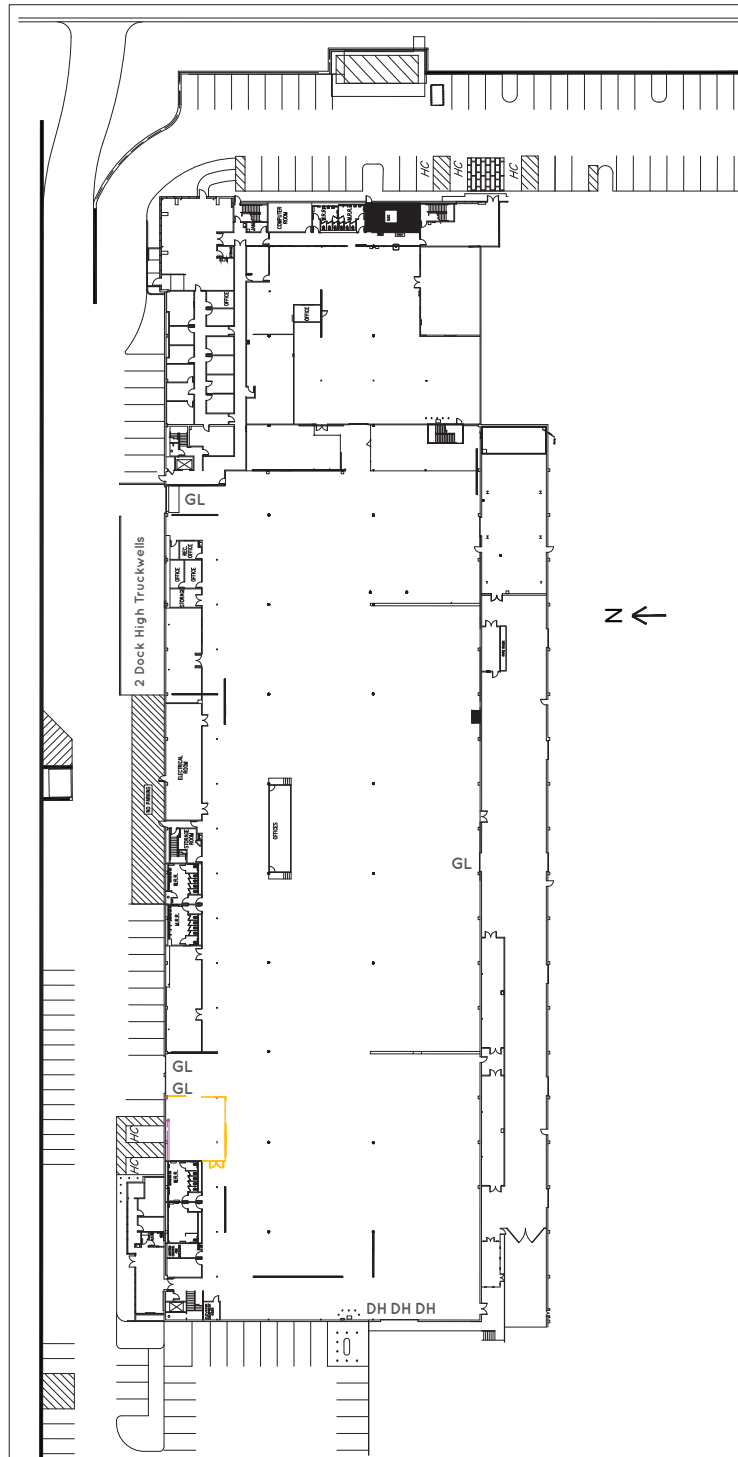

2nd Floor

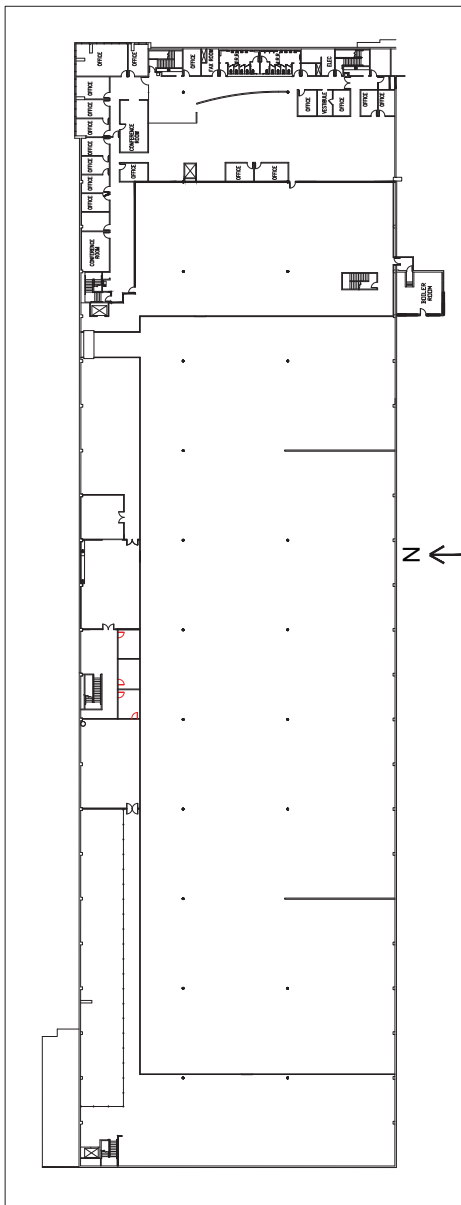

**ADAM HILL**

Senior Associate

714.935.2311

Lic. #01970562

**SETH DAVENPORT**

Executive Vice President

714.935.2376

Lic. #01413387

**MITCH ZEHNER**

Executive Vice President

714.935.2307

Lic. #00882464

