

# 22895 EASTPARK DRIVE YORBA LINDA, CA

**For Lease**  
**±34,972 SF**



## Building Features

- High Image Industrial Building - Corporate Headquarters
- ±12,262 Square Feet of Office Space
- 3 Grade Level Loading Doors
- 18' Minimum Warehouse Clearance
- Fully Fire Sprinklered
- 4.0:1 Parking Ratio
- Located within Savi Ranch
- Drive Around Building
- Enclosed Yard Area - Possible
- Abundant Retail and Dining Amenities
- Excellent proximity to 241 Toll Road and Riverside 91 and 55 Freeways

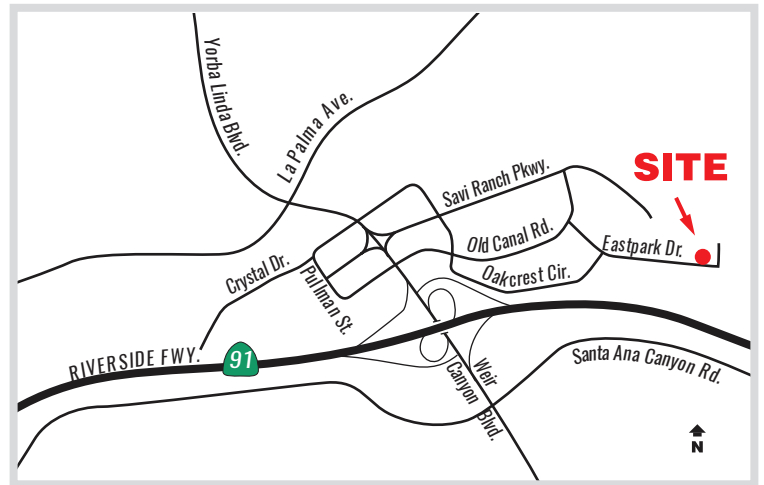

### MITCH ZEHNER

Executive Vice President  
714.935.2307  
Lic. #00882464

### SETH DAVENPORT

Executive Vice President  
714.935.2376  
Lic. #01413387

**Voit**  
REAL ESTATE SERVICES

**THE ZEHNER  
DAVENPORT**  
INDUSTRIAL GROUP

# 22895 EASTPARK DRIVE YORBA LINDA, CA

**For Lease**  
**±34,972 SF**

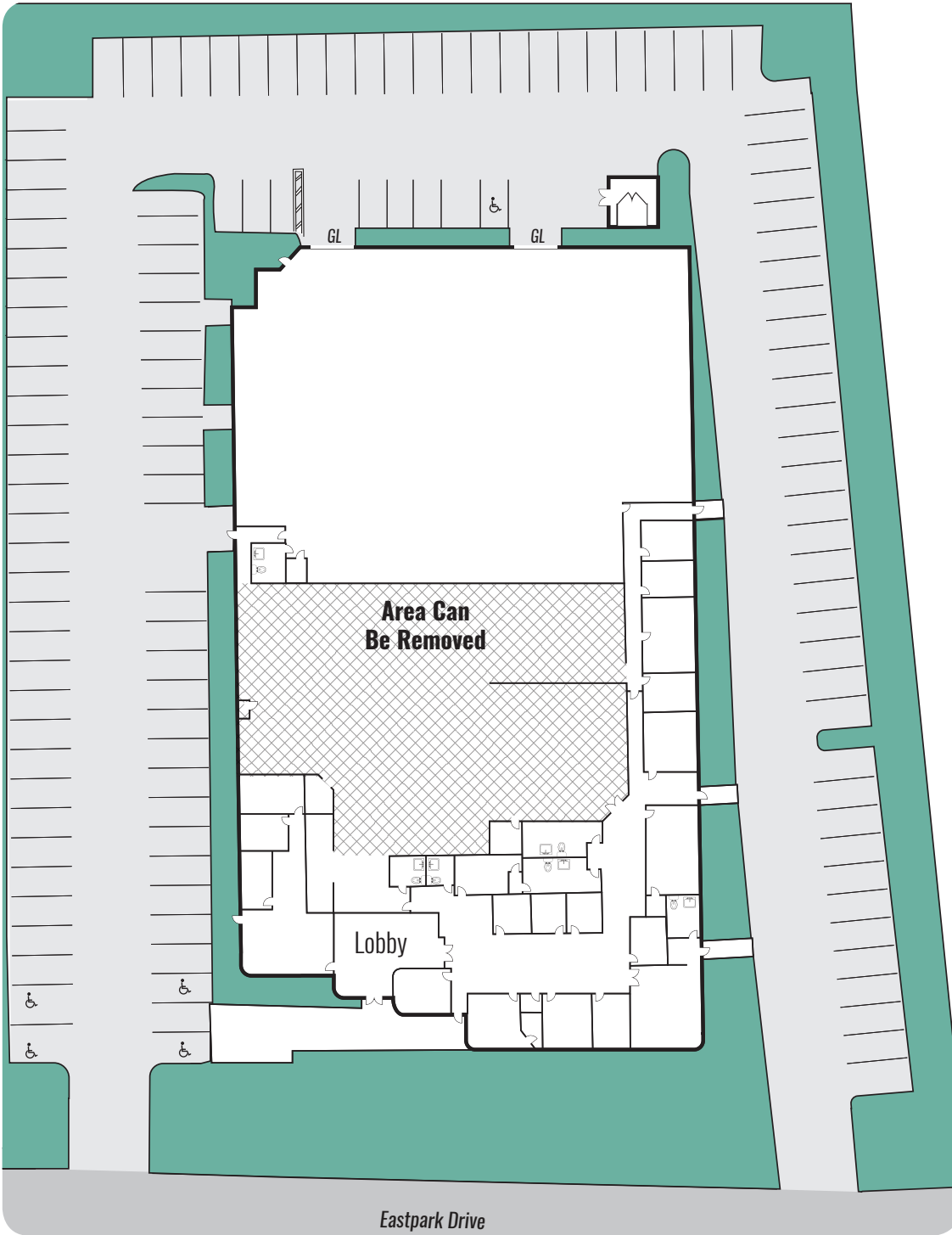

**MITCH ZEHNER**  
Executive Vice President  
714.935.2307  
Lic. #00882464

**SETH DAVENPORT**  
Executive Vice President  
714.935.2376  
Lic. #01413387

**Voit**  
REAL ESTATE SERVICES

**THE ZEHNER  
DAVENPORT**  
INDUSTRIAL GROUP