

FOR SALE ±22,329 Sq. Ft.



940 Challenger Street, Brea

Property Details

- Freestanding Industrial Building
- ±6,105 Square Feet of Office Space
- 1 Ground Level Loading Door
- 2 Dock High Loading Doors
- 24' Warehouse Ceiling
- 800 Amps, 277/480 Volt Service
- 2:1 Parking Ratio
- Fire Sprinklered
- Immediate Access to Orange (57) Freeway
- Highly Desirable North Orange County location with ideal proximity to infrastructure, and a strong labor pool
- Business Park Environment
- Excellent Freeway Access
- Onsite Cell Tower With \$31,512 In Annual Income Also Available

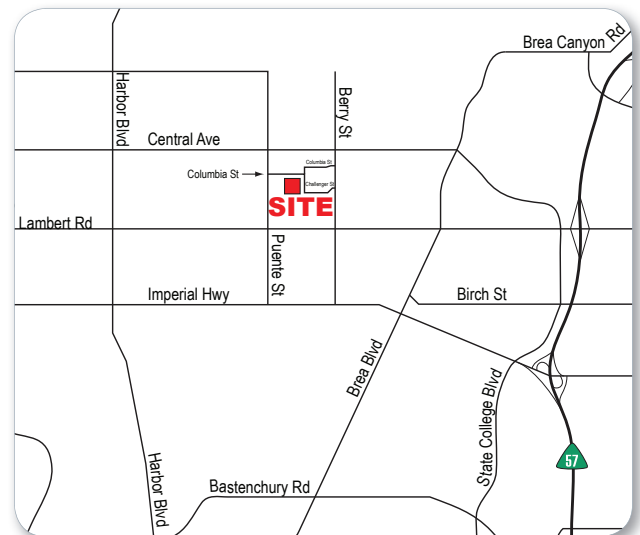

Seth Davenport

714.935.2376
sdavenport@voitco.com
Lic.#01413387

Mitch Zehner

714.935.2307
mzehner@voitco.com
Lic.#00882464

Voit
REAL ESTATE SERVICES

**THE ZEHNER
DAVENPORT**
INDUSTRIAL GROUP

FOR SALE ±22,329 Sq. Ft.

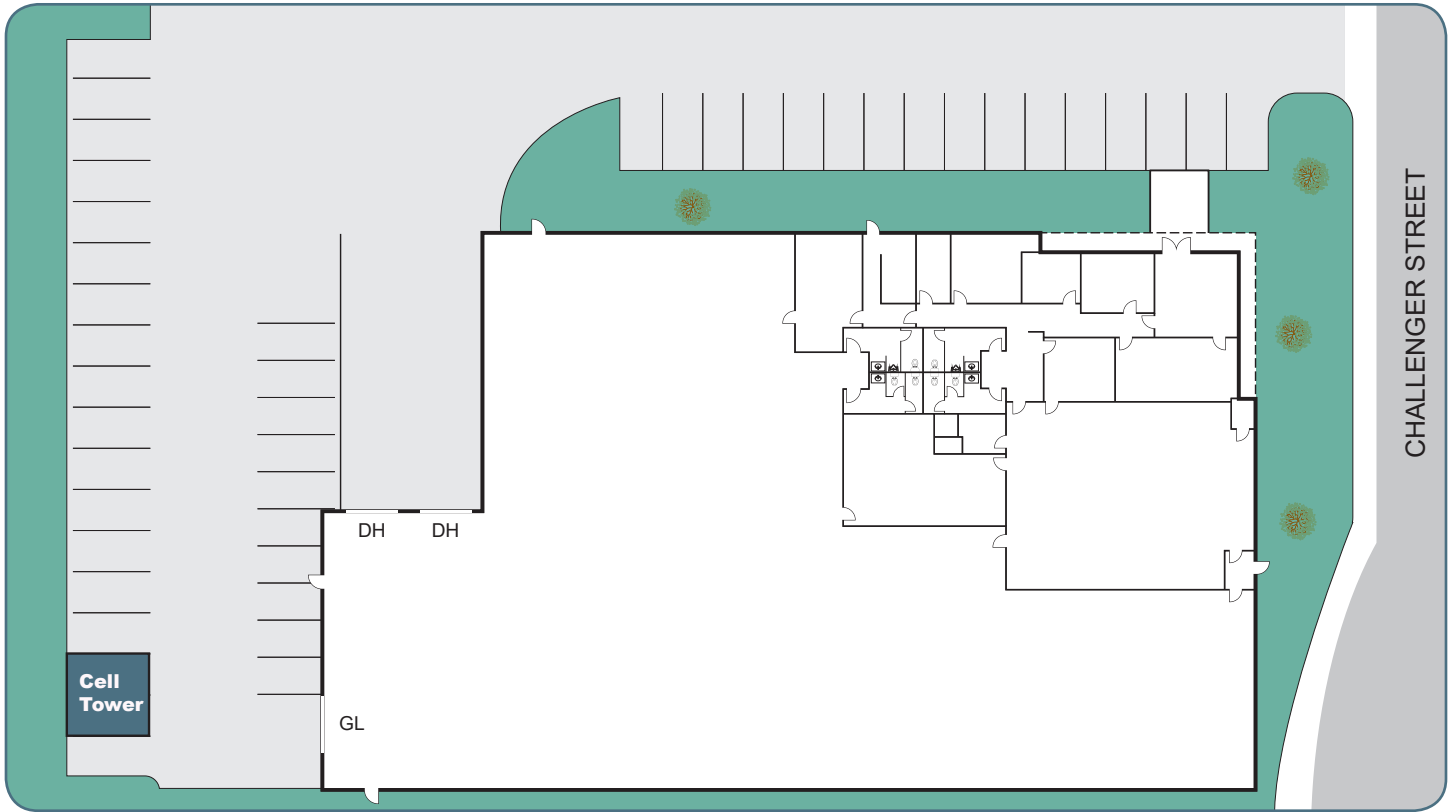

*Floor Plan Not to Scale

Seth Davenport

714.935.2376
sdavenport@voitco.com
Lic.#01413387

Mitch Zehner

714.935.2307
mzehner@voitco.com
Lic.#00882464

Voit
REAL ESTATE SERVICES

**THE ZEHNER
DAVENPORT**
INDUSTRIAL GROUP