

210

S. RANGER AVENUE

BREA | CALIFORNIA



FOR LEASE | 17,242 SF

Voit
REAL ESTATE SERVICES

ZEHNER HILL
INDUSTRIAL GROUP

PROPERTY DETAILS & SITE PLAN

- ± 17,242 Sq. Ft. POL of a Larger Distribution/ MFG Bldg
- ± 1,750 Sq. Ft. of Office Space
- 1 Grade Level Loading Door
- 2 Dock High Loading Platforms
- 22'-24' Warehouse Height
- 600 Amps 277/480 Power (VERIFY)
- 2:1,000 Parking Ratio
- Fire Sprinklered
- SIGNALIZED CORNER
- Immediate Access to Orange (57) Freeway
- Highly Desirable North Orange County Location

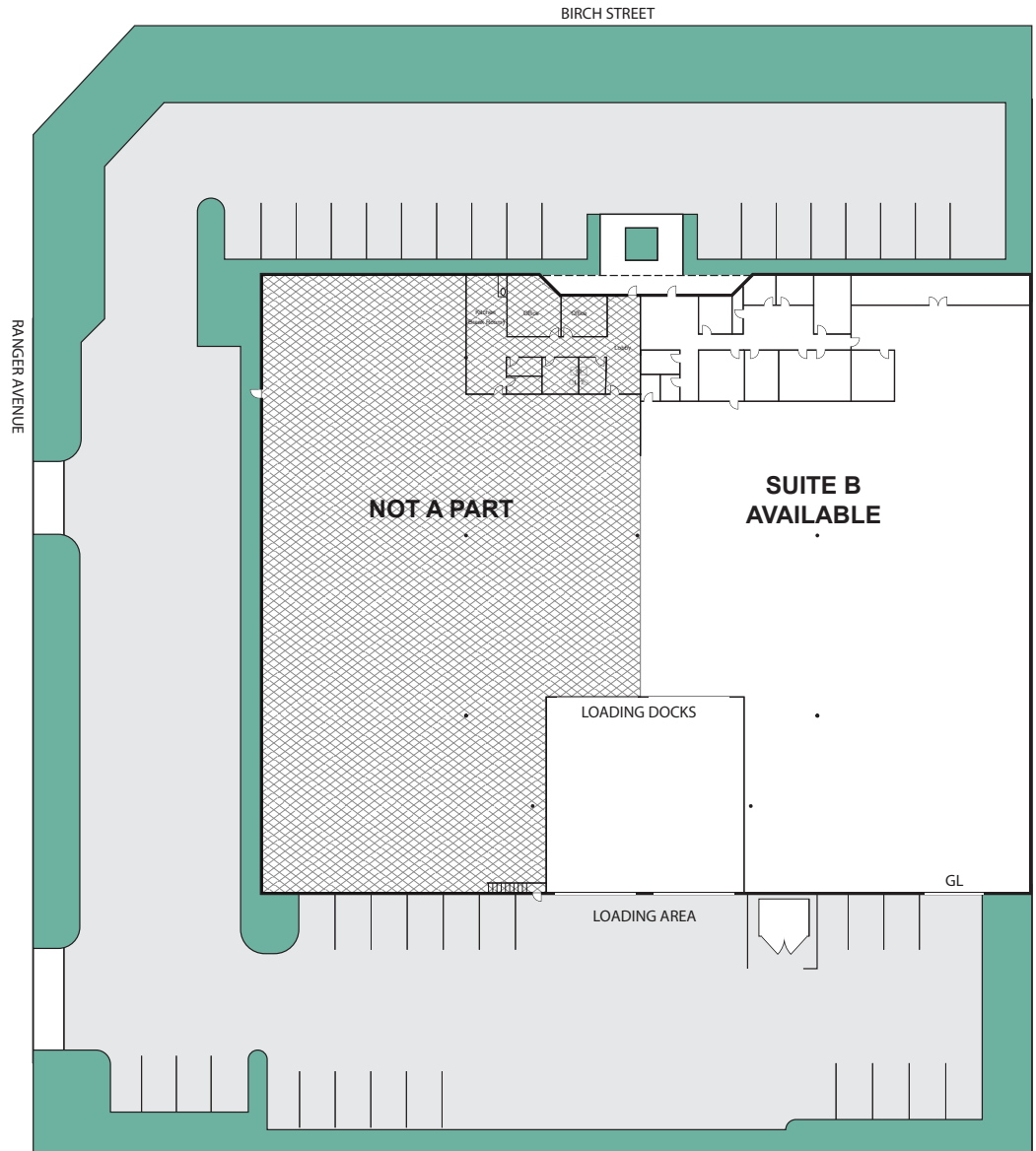
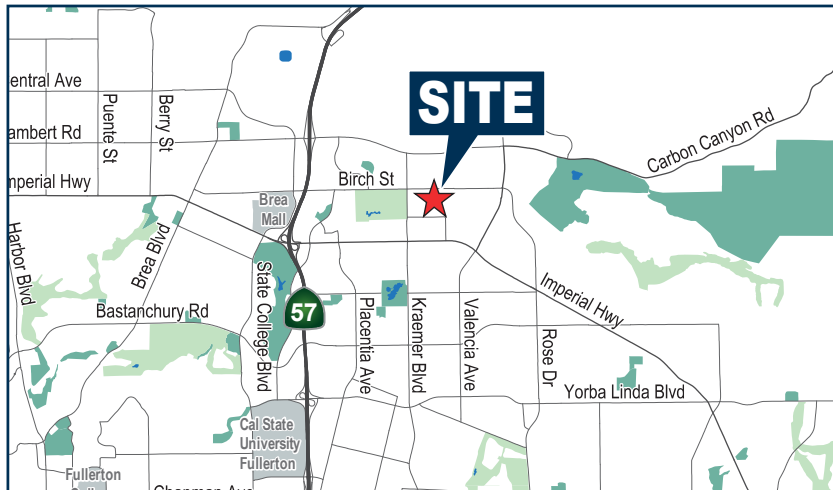

MITCH ZEHNER
EXECUTIVE VICE PRESIDENT
 714.935.2307
 MZehner@voitco.com
 Lic. #00882464

MICHAEL ZEHNER
SENIOR VICE PRESIDENT
 714.935.2328
 McZehner@voitco.com
 Lic. #01917963

ADAM HILL
SENIOR VICE PRESIDENT
 714.935.2311
 AHill@voitco.com
 Lic. #01970562

Voit
 REAL ESTATE SERVICES

ZEHNER HILL
 INDUSTRIAL GROUP

2020 Main Street | Suite 100
 Irvine, California 92614
 949.851.5100 | www.VoitCo.com

The information contained herein has been obtained from sources we deem reliable. While we have no reason to doubt its accuracy, we do not guarantee it. Licensed as Real Estate Salespersons by the DRE. ©2025 Voit Real Estate Services, Inc. All Rights Reserved. License #01991785.