

FOR LEASE 27,658 SF

2330 ARTESIA AVENUE, SUITE A
FULLERTON, CALIFORNIA

ARTESIA DISTRIBUTION CENTER



2330 ARTESIA AVENUE, SUITE A

FULLERTON, CALIFORNIA

PROPERTY FEATURES

- Freestanding Manufacturing / Distribution Building
- ±2,500 Square Feet of Office Space
- ±25,158 Square Feet of Warehouse Space
- 600 AMPS 277/480 Volts (verify)
- Fire Sprinklered .45/3,000
- 24' Warehouse Clearance
- Concrete Loading Aprons
- 1 Ground Level Loading Door (12'x14')
- 5 Dock High Loading Doors (9'x11')
- Excellent Corporate Location in Fullerton
- Building with Excellent Truck Circulation
- Large Staging Area
- Access off Two Major Streets (Artesia Avenue & Commonwealth Avenue)
- Immediate Freeway Access to 5 & 91 Freeways
- 25 Miles to the Ports of Long Beach & Los Angeles

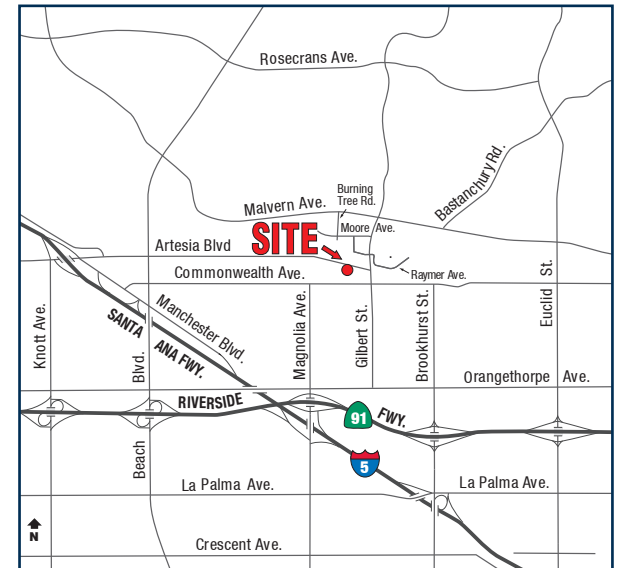

FOR MORE INFORMATION PLEASE CONTACT

MITCH ZEHNER
EXECUTIVE VICE PRESIDENT
 714.935.2307
 MZehner@voitco.com
 Lic. #00882464

MICHAEL ZEHNER
SENIOR VICE PRESIDENT
 714.935.2328
 McZehner@voitco.com
 Lic. #01917963

ADAM HILL
SENIOR VICE PRESIDENT
 714.935.2311
 AHill@voitco.com
 Lic. #01970562

Voit

REAL ESTATE SERVICES

ZEHNER HILL

INDUSTRIAL GROUP

2020 Main Street, Suite 100 | Irvine, California 92614
 949.851.5100 | 949.261.9092 Fax | Lic #01991785
www.VoitCo.com

2330 ARTESIA AVENUE, SUITE A

FULLERTON, CALIFORNIA

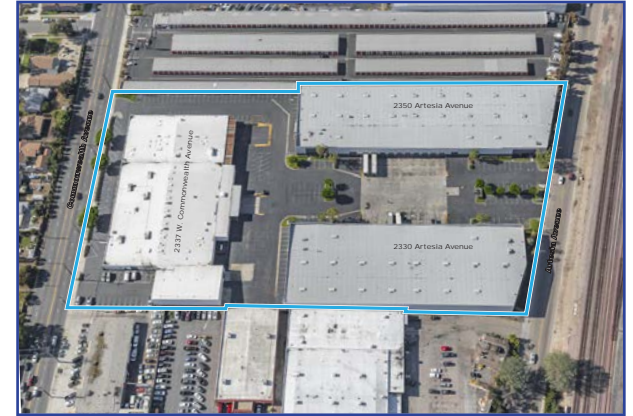
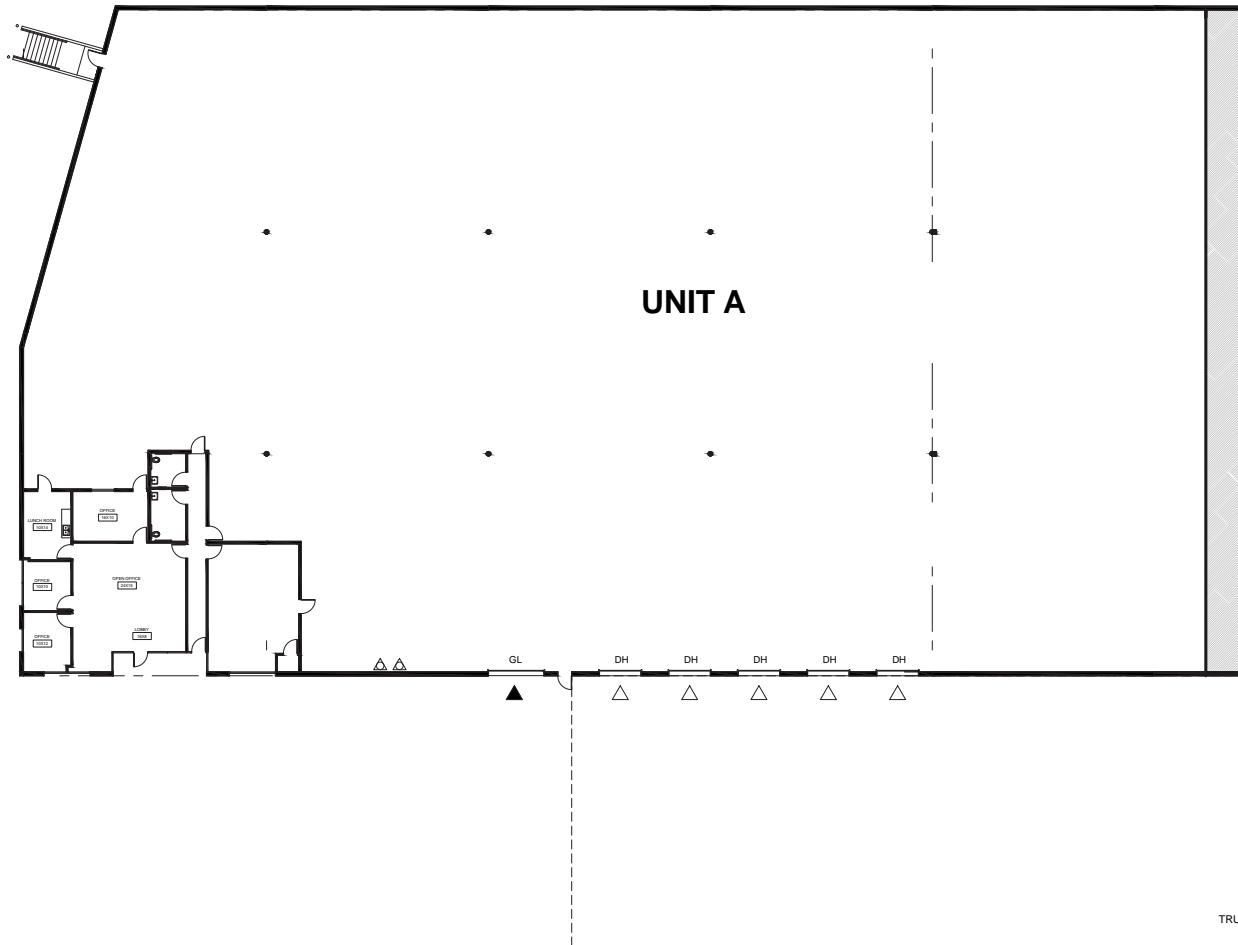

FOR MORE INFORMATION PLEASE CONTACT

MITCH ZEHNER
EXECUTIVE VICE PRESIDENT
714.935.2307
MZehner@voitco.com
Lic. #00882464

MICHAEL ZEHNER
SENIOR VICE PRESIDENT
714.935.2328
McZehner@voitco.com
Lic. #01917963

ADAM HILL
SENIOR VICE PRESIDENT
714.935.2311
AHill@voitco.com
Lic. #01970562

Voit

REAL ESTATE SERVICES

ZEHNER HILL

INDUSTRIAL GROUP

2020 Main Street, Suite 100 | Irvine, California 92614
949.851.5100 | 949.261.9092 Fax | Lic #01991785
www.VoitCo.com

2330 ARTESIA AVENUE, SUITE A
FULLERTON, CALIFORNIA

